

COMPT.	DOOR OPENING	COMPARTMENT DIMENSIONS		
		INTERIOR	DIVIDE HEIGHT	UNDER DEPTH
L1	56"W x 57"H	61.5"W x 73.5"H	30"	14" 23"
L2	28"W x 24"H	39.5"W x 40"H	-	14" 14"
L3	49"W x 22"H	52"W x 34"H	-	14" 14"
L4	18"W x 53"H	28.5"W x 64.75"H	25"	14" 23"
R1	56"W x 57"H	61.5"W x 73.5"H	30"	14" 23"
R2	28"W x 24"H	39.5"W x 40"H	-	14" 14"
R3	49"W x 22"H	52"W x 34"H	-	14" 14"
R4	42"W x 53"H	49.5"W x 64.75"H	25"	14" 23"

GROUND LADDERS & PIKE POLES			
ITEM	DESCRIPTION	MODEL #	QTY
A	35' 3 SEC EXTENSION	1225-A	1
B	24' 2 SEC EXTENSION	900-A	1
C	16' ROOF (AERIAL BASE)	875-A	1
D	14' ROOF	775-A	1
E	14' FRESNO ATTIC	701	1
F	10' FOLDING ATTIC	585-A	1
G	4' D-HANDLE PIKE POLE	FP4D	2
H	6' PIKE POLE	FP6	2
I	8' PIKE POLE	FP8	2
J	12' PIKE POLE	FP12	2

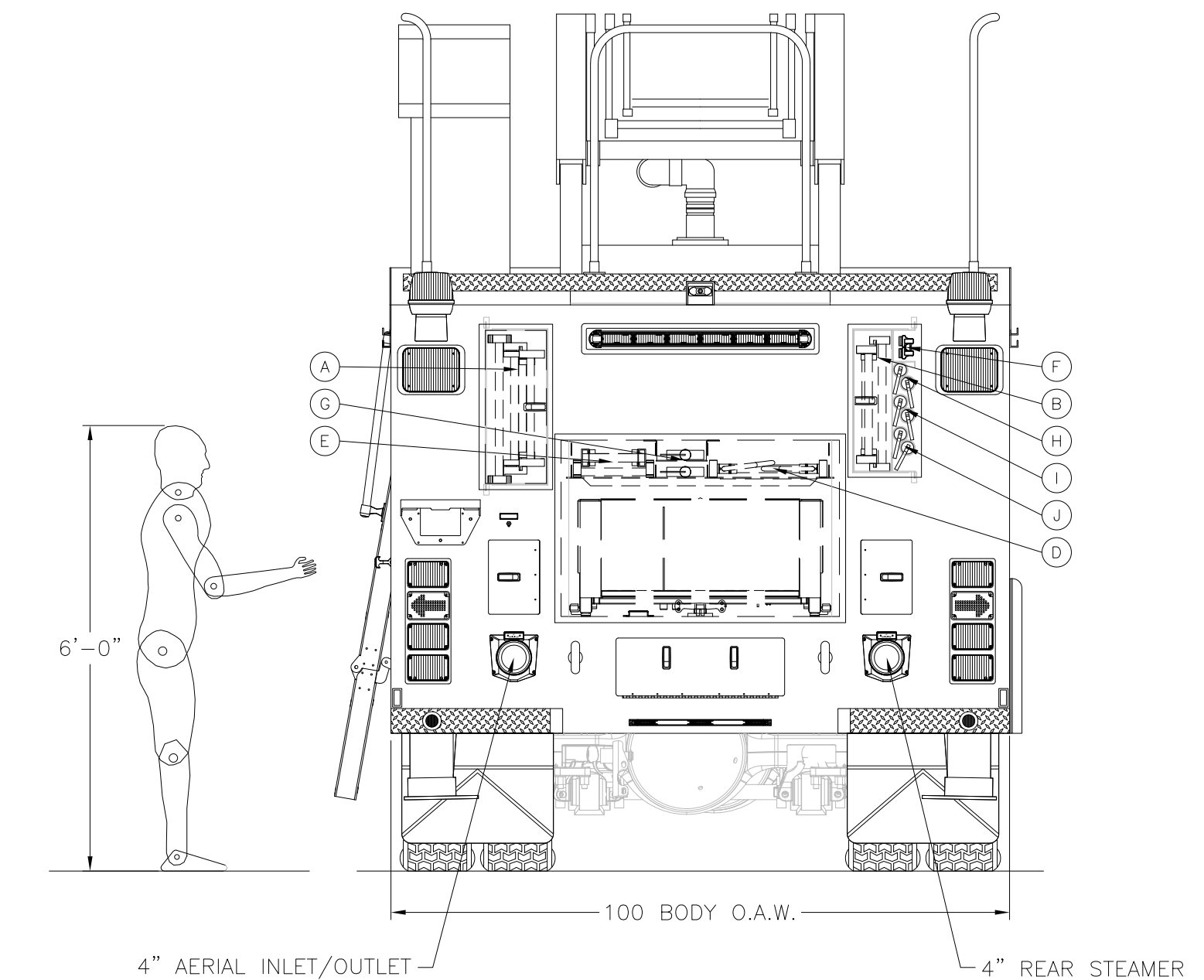

NOTE:
 THIS DRAWING IS THE PROPERTY OF SPARTAN MOTORS USA AND IS TO BE USED ONLY IN REFERENCE TO THE WORK PROPOSED OR CONTRACTED BY SPARTAN MOTORS USA ANY REPRODUCTION IN PART OR IN WHOLE WITHOUT THE WRITTEN PERMISSION OF SPARTAN MOTORS USA IS STRICTLY PROHIBITED.
 DIMENSIONS SHOWN ARE APPROXIMATE AND ARE SUBJECT TO CHANGE AS MAY BE FOUND NECESSARY DURING CONSTRUCTION. THIS DRAWING MUST BE PLOTTED TO THE PAPER SIZE LISTED IN THE TITLE BLOCK FOR THE LISTED SCALE TO BE VALID.
 THIS DRAWING IS FOR REFERENCE PURPOSES ONLY. SOME ITEMS MAY OR MAY NOT APPEAR ON THE DRAWING THAT MAY OR MAY NOT BE INCLUDED IN THE SPECIFICATIONS. THE SPECIFICATIONS SHALL BE THE FINAL AUTHORITY TO DETERMINE WHAT IS SUPPLIED ON THE APPARATUS.

REV.	INT.	DATE	REVISION HISTORY DESCRIPTION
01	CL	9/20/17	COPY OF 18625-01 WITH EHL

PROPOSAL

CHASSIS: SPARTAN METRO STAR MFD FLAT ROOF
 ENGINE: CUMMINS L9 450HP WITH ALLISON 3000 EVS
 PUMP: WATEROUS CSUC20 2000 GPM RATED AT 1750 IGPM
 WATER TANK: 450 U.S. GAL
 FOAM CELL: N/A
 BODY MATERIAL: 1/8" ALUMINUM
 HOSE BEDS: 800' OF 4" & 400' OF 2-1/2" / 39 CUBIC FEET
 GENERATOR: SMART POWER BKW HR-8
 COMPARTMENTS: 153 CUBIC FEET

DISTRICT OF SUMMERLAND SUMMERLAND, BC			
MODEL:	75' REAR MOUNT AERIAL		
DEALERSHIP:	SAFETEK EMERGENCY VEHICLES		
SCALE:	1/2" = 1'	DRAWN BY:	CL
		DATE:	9/20/17
SHEET:	1 OF 1	DRAWING NO.:	18730
		REV.:	01