

COMPT.	DOOR OPENING	INTERIOR	DIVIDE HEIGHT	USG. DEPTH	WGT.
L1	31"W x 58"H	36"W x 66"H	N/A	26"	25"
L2	59"W x 26"H	69"W x 32"H	N/A	26"	N/A
L3	47"W x 58"H	50"W x 66"H	N/A	26"	26"
R1	31"W x 58"H	36"W x 66"H	27"	15"	26"
R2	59"W x 26"H	69"W x 32"H	N/A	15"	N/A
R3	47"W x 58"H	50"W x 66"H	27"	15"	26"
T1	39"W x 32"H	46"W x 40"H	N/A	25"	25"
H1-4	18"W x 66"L	25"W x 70"L	N/A	16"	16"

ITEM	DESCRIPTION	MODEL #	QTY
A	24' 2-SEC EXTENSION	900-A	1
B	14' ROOF	775-A	1
C	10' FOLDING ATTIC	585-A	1
D	6' FOLDING	CJL-10	1
E	PIKE POLE		3

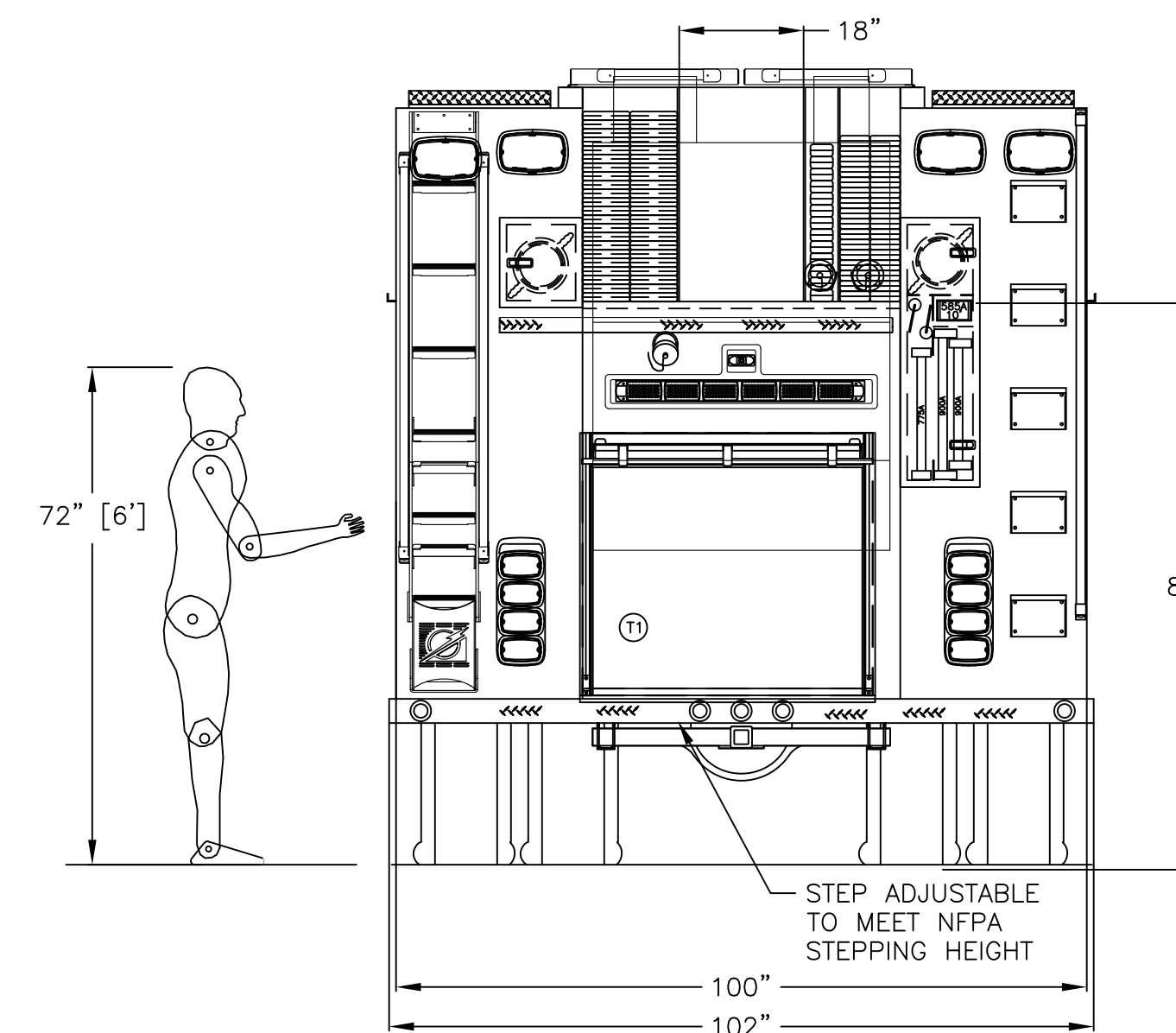
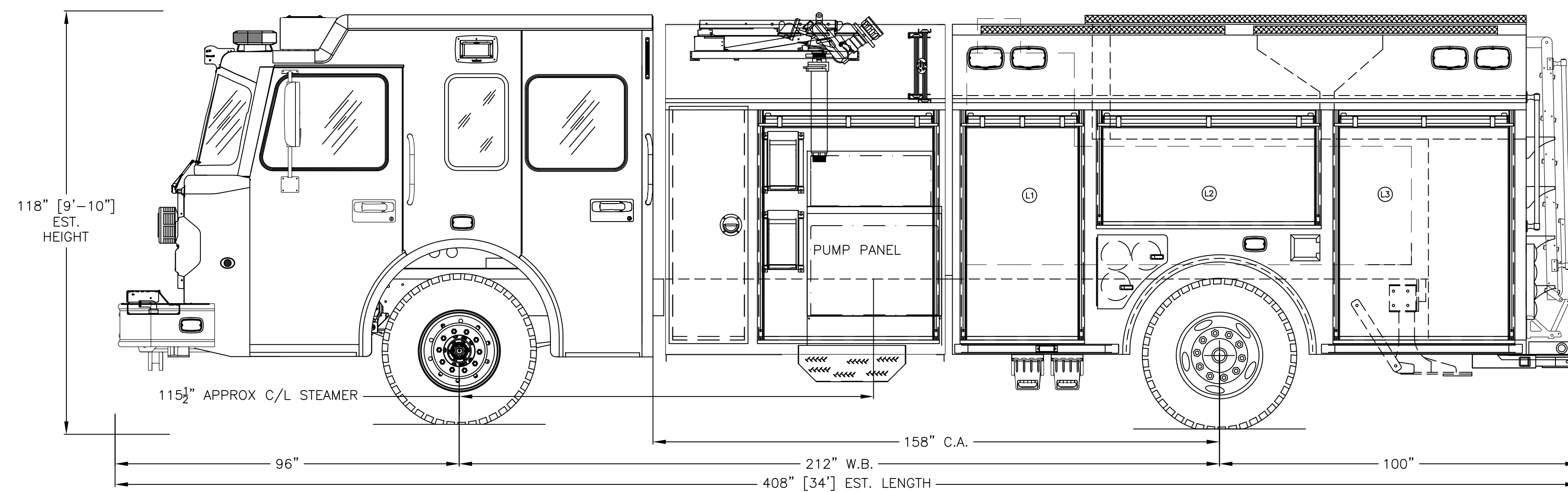

NOTE:
 THIS DRAWING IS THE PROPERTY OF SPARTAN MOTORS USA AND IS TO BE USED ONLY IN REFERENCE TO THE WORK PROPOSED OR CONTRACTED BY SPARTAN MOTORS USA ANY REPRODUCTION IN PART OR IN WHOLE WITHOUT THE WRITTEN PERMISSION OF SPARTAN MOTORS USA IS STRICTLY PROHIBITED.
 DIMENSIONS SHOWN ARE APPROXIMATE AND ARE SUBJECT TO CHANGE AS MAY BE FOUND NECESSARY DURING CONSTRUCTION. THIS DRAWING MUST BE PLOTTED TO THE PAPER SIZE LISTED IN THE TITLE BLOCK FOR THE LISTED SCALE TO BE VALID.
 THIS DRAWING IS FOR REFERENCE PURPOSES ONLY. SOME ITEMS MAY OR MAY NOT APPEAR ON THE DRAWING THAT MAY OR MAY NOT BE INCLUDED IN THE SPECIFICATIONS. THE SPECIFICATIONS SHALL BE THE FINAL AUTHORITY TO DETERMINE WHAT IS SUPPLIED ON THE APPARATUS.

REV.	INT.	DATE	REVISION HISTORY DESCRIPTION
01	Brodd	07/14/17	ORIGINAL LAYOUT FOR BID

PROPOSAL

CHASSIS: SPARTAN METRO STAR MFD 10" RAISED ROOF
 ENGINE: CUMMINS L9 450HP WITH ALLISON 3000 EVS
 PUMP: WATEROUS CSUC20 1500 GPM (RATED @ 5000LPM)
 WATER TANK: 600 IMPERIAL GALLONS
 FOAM CELL: 20 IMPERIAL GALLONS
 BODY MATERIAL: 1/8" ALUMINUM
 HOSE BED: 98 CUBIC FEET
 GENERATOR: SMART POWER 10KW
 COMPARTMENTS: 219 CUBIC FEET



SMEAL
 A SPARTAN MOTORS BRAND
 610 W 4TH ST
 SNYDER, NE
 PHONE: (402) 568-2224
 WWW.SMEAL.COM

ST. CATHARINES FIRE SERVICES
 ST. CATHARINES, ON
 MODEL: SIDE MOUNT PUMPER
 DEALERSHIP: SAFETEK
 SCALE: 1/2" = 1'
 DRAWN BY: D.Brodd DATE: 07/14/17
 SIZE: 24" X 36"
 DRAWING NO: 17759 REV: 01
 SHEET: 1 OF 1